

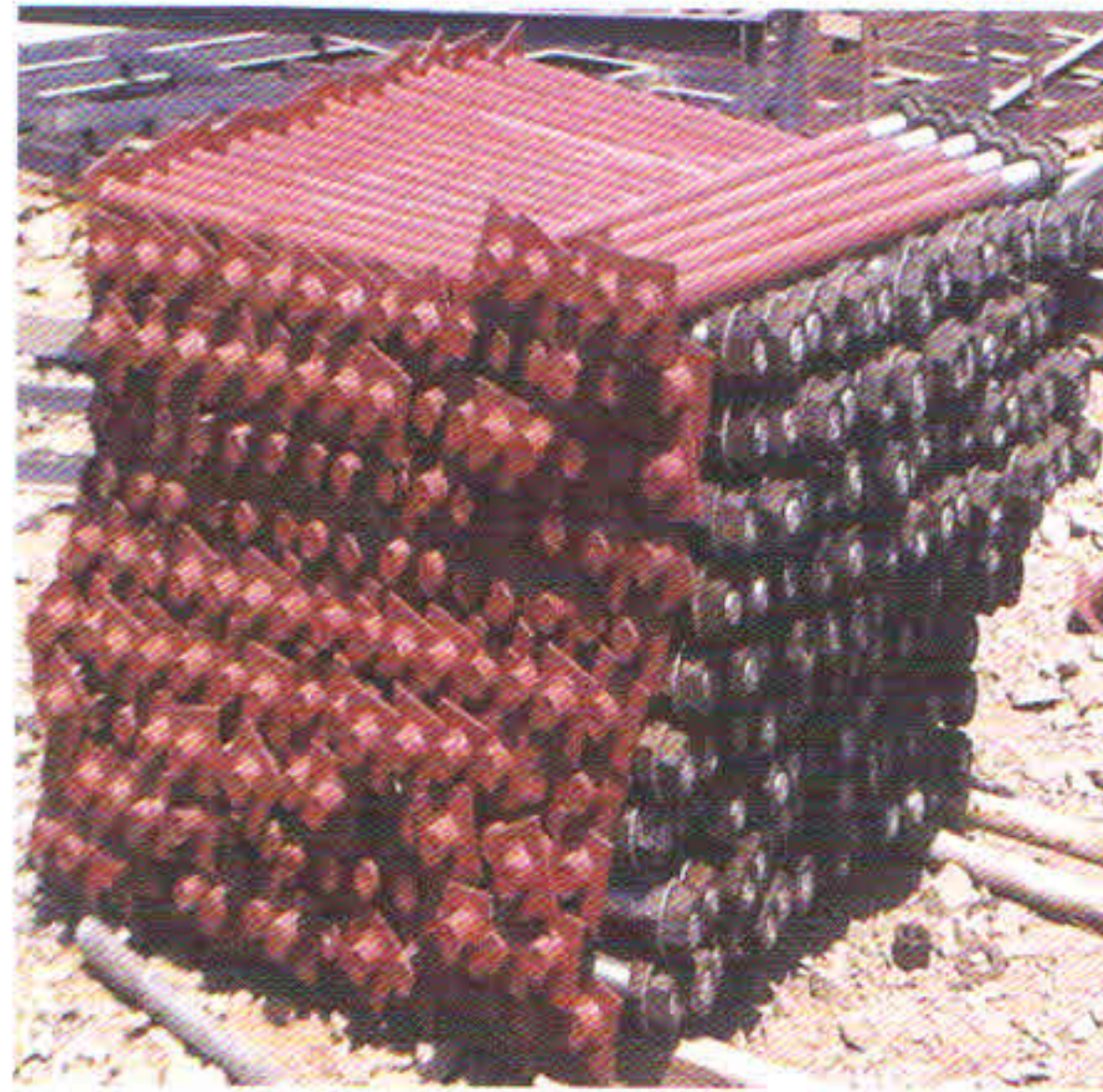

PRODUCTS



HSFG Bolts



Foundation Bolts

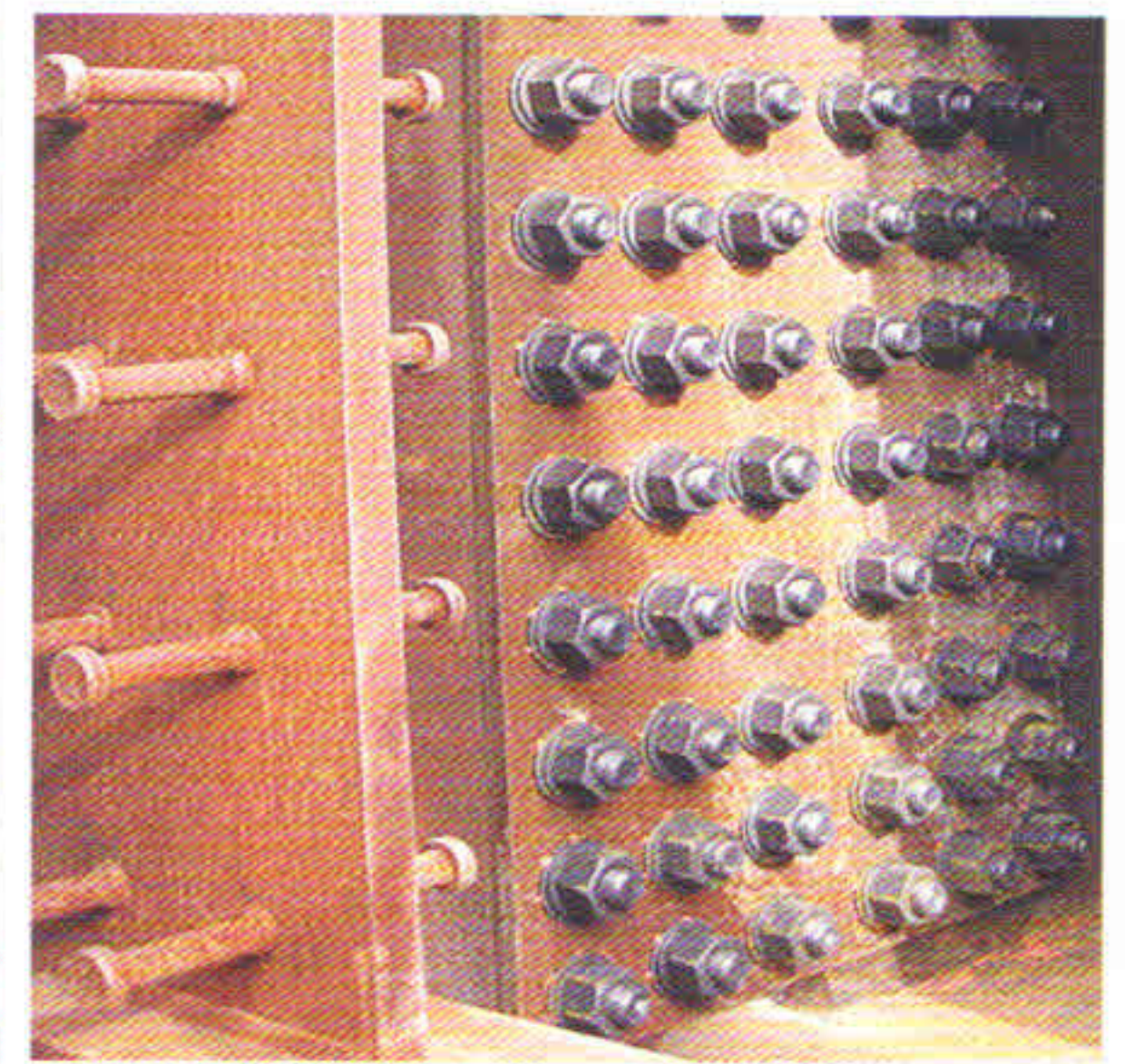

Infrastructure / Airport

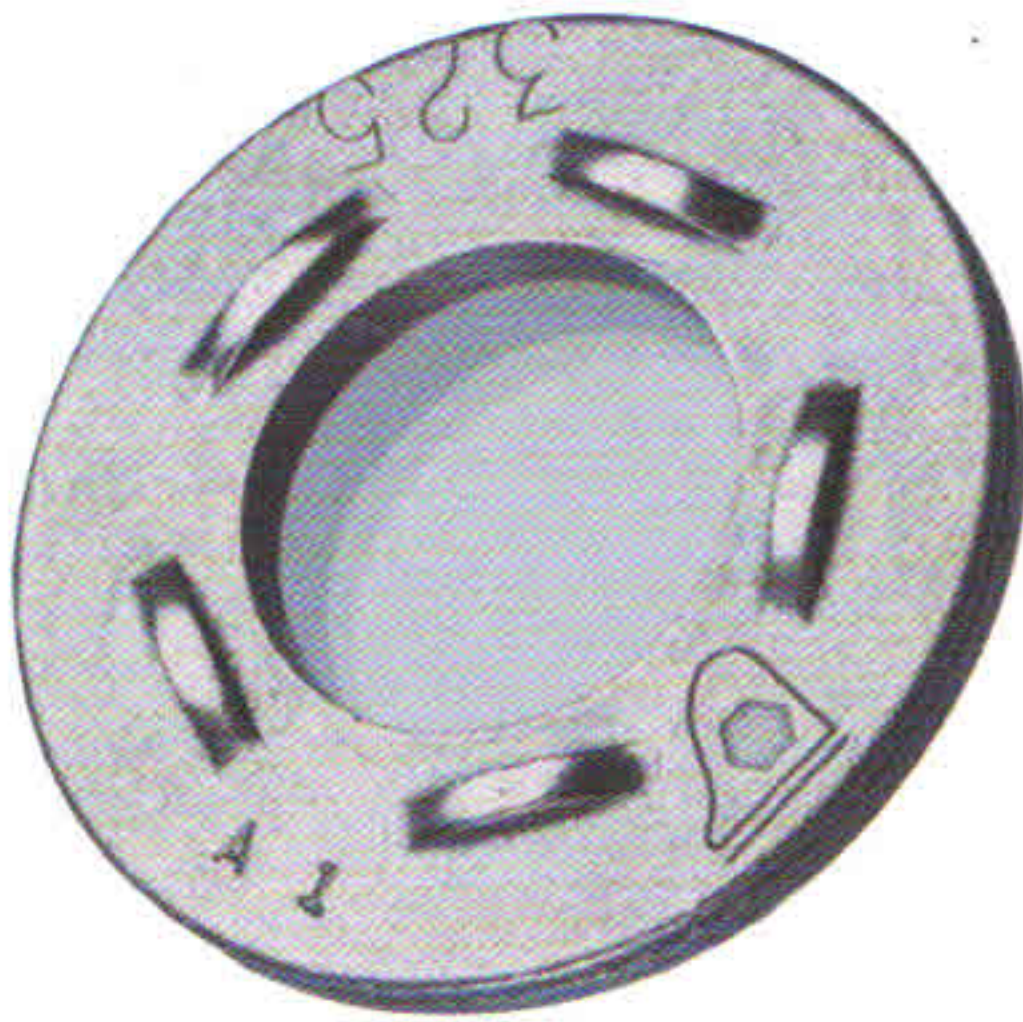

Squirter DTI



Super Alloy Fasteners



Shear Studs & Threaded Studs



Rail Over Bridge

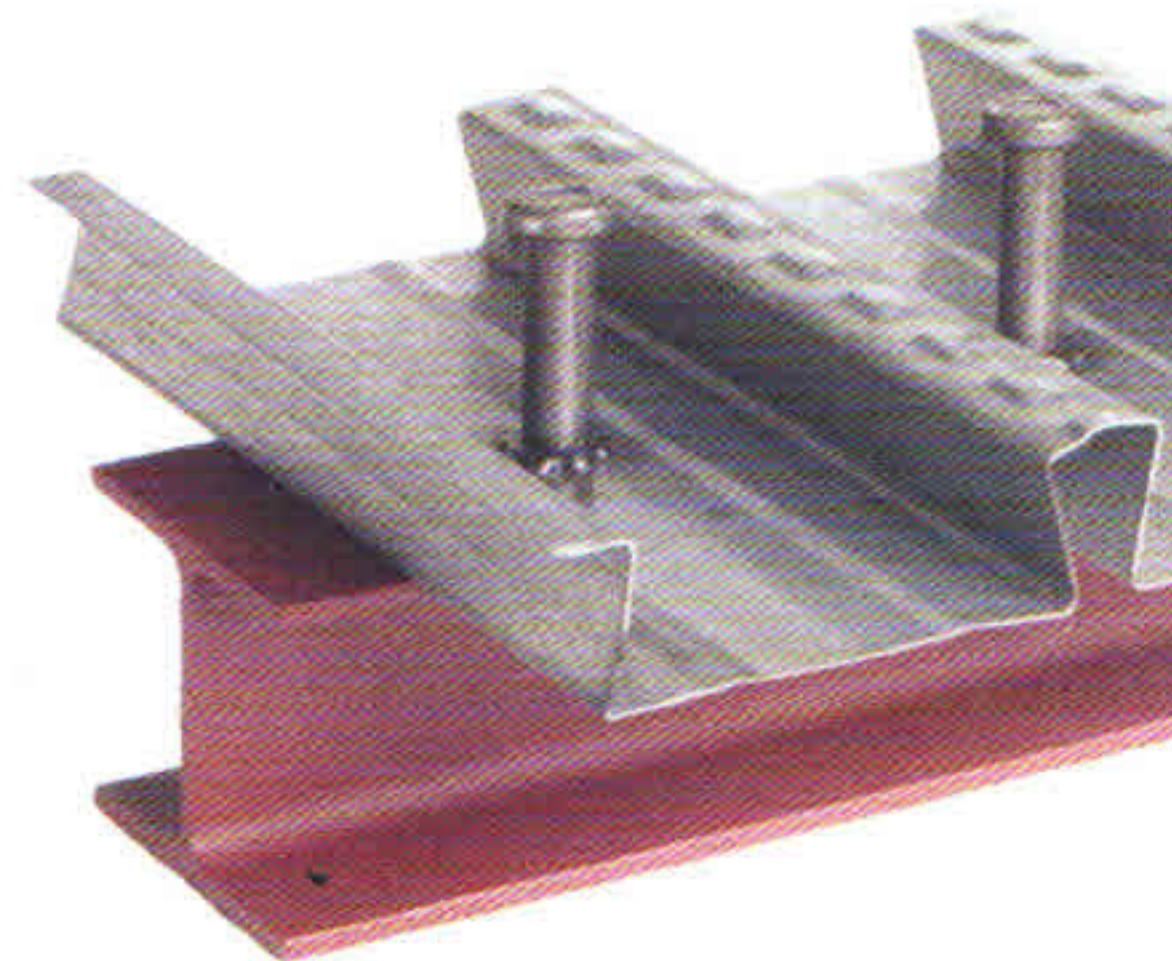

Through Deck Welding

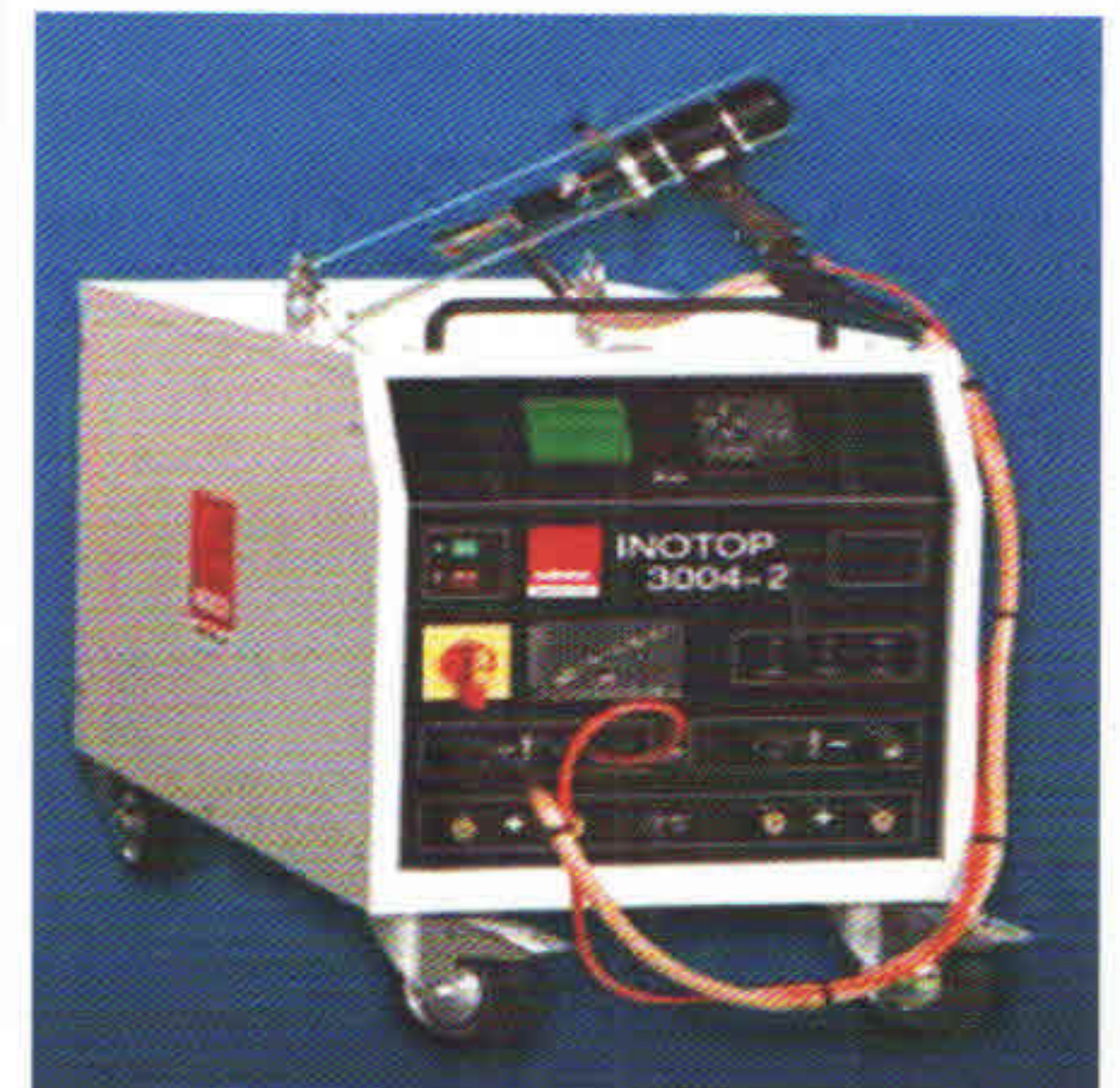

Stud Welding Machine

SURECON FASTENING & ENGINEERING PVT. LTD.

ISO 9001

BUREAU VERITAS
Certification



An ISO 9001 Co.



Founded in August 2009, Surecon's success is based on the motto "Progress, Best Quality, Globalization, Superior Service".

Its group companies have over 50 years of experience in the manufacture and supply of fasteners. The company is dedicated to excellence and we provide only the best quality products to our customers. Our excellent after-sales service is our hallmark.

Surecon is fully equipped with manufacturing facilities of fasteners in the industrial hub of India i.e Mumbai. It has several offices across India and Asia. It is very well versed with the needs of industrial engineering products and services of the customer.

"Surecon Fastening & Engineering's Product List :

- Foundation / Anchor Bolts
- Hex / HSFG Fasteners
- Shear studs / Shear connectors
- Stud Welding Machine
- D.T.I.'s
- Super Alloy & Special Fasteners

Surecon is an approved vendor of various Indian government organisations such as Railways, RITES, NTPC etc. It is also a registered vendor of leading engineering/infrastructure companies such as Larsen and Toubro, Reliance, Eversandai etc. Surecon and its group companies also supply products to the Indian Defence Organisations.

Surecon is a regular supplier of engineering products to Africa (Nigeria, Senegal etc.)

Projects:

- Oil & Gas / Refinery : Reliance Industries Limited (Jamnagar)
- Telecommunication : 4G Tower fasteners
- Railways / NHAI (Bridges) : Ganga Rail cum Road Bridge / Munger Rail cum Road Bridge
Road Over Bridges across India
- Power Sector : Sasan Ultra Mega Power Project
Solar / Mauda Thermal power projects
- Airports : MIAL (Mumbai International Airport)
BIAL (Bangalore International Airport)
MRO Boeing project
- Building / Factories : Nirmal Lifestyle Mall
L & T Powai / L& T Hazira
Cold Rolling Mill 2



HIGH STRENGTH FRICTION GRIP (HSFG) HEAVY SERIES BOLTING

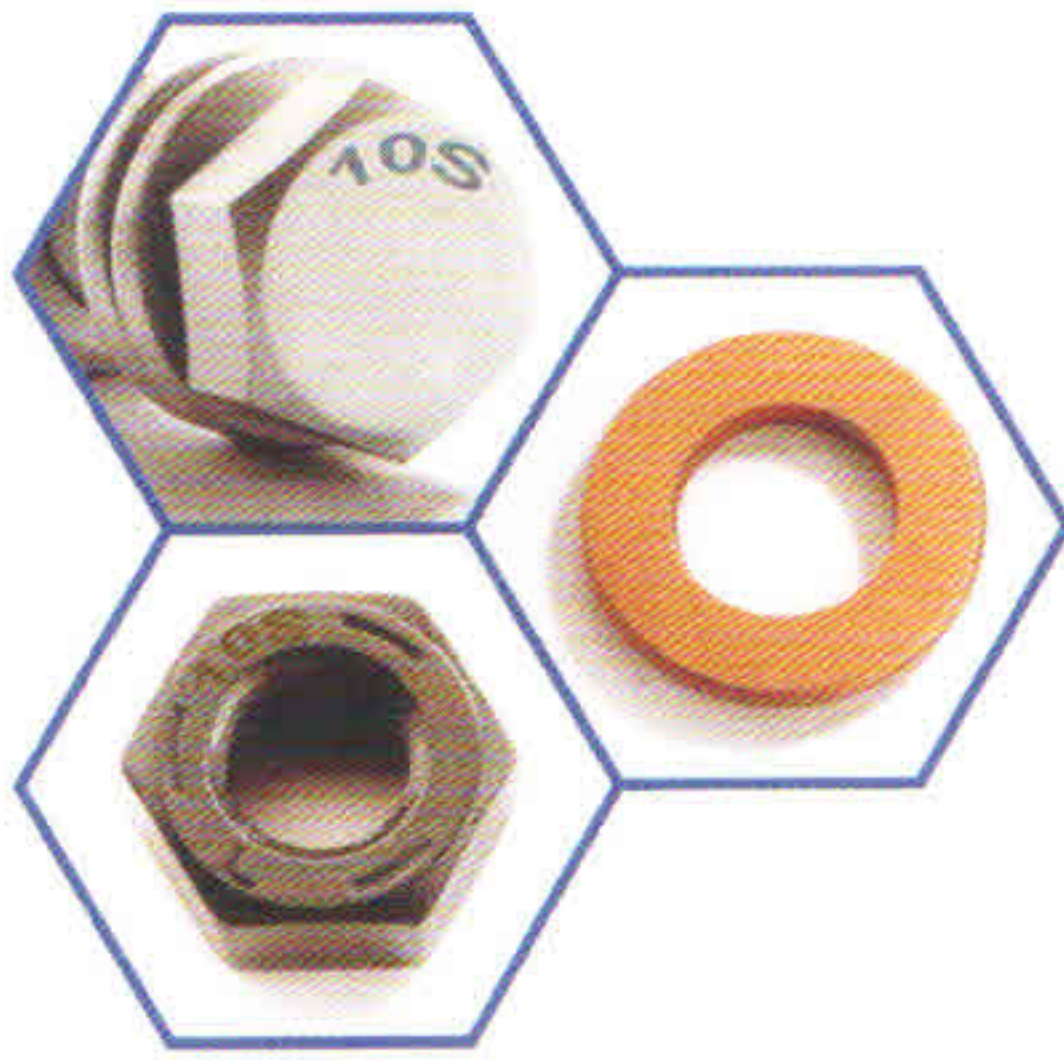

Introduction:

High Strength Friction Grip Bolts (HSFG) are high strength structural bolts which have been tightened such as to induce tension in the bolt shank.

Due to the tension in the bolt, the interface between the plies (steel members in a joint) cannot move relative to each other because of the friction resistance. The bolts act differently than normal bolts or rivets.

This method of joining structural steelwork has been a well established, efficient and cost effective system used for many years.

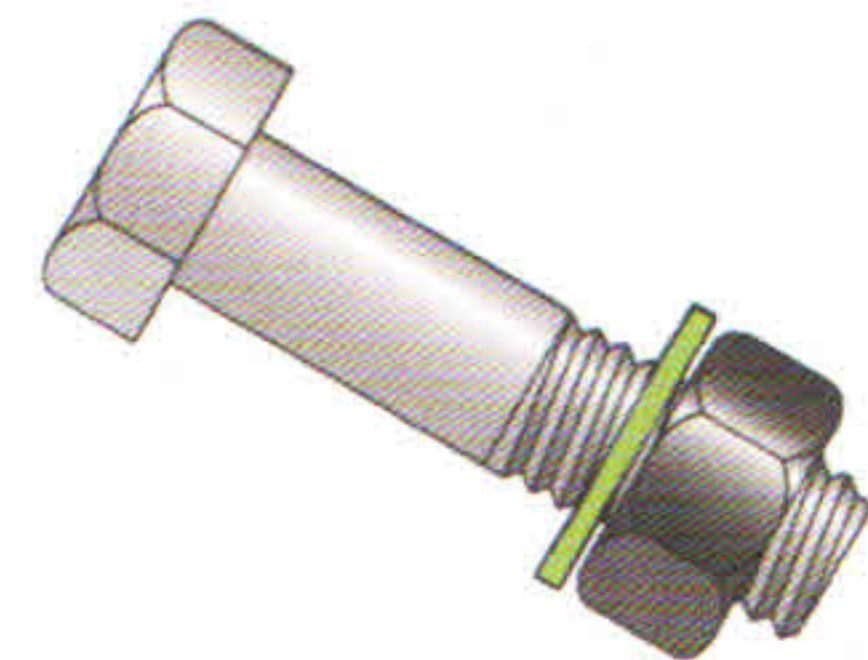
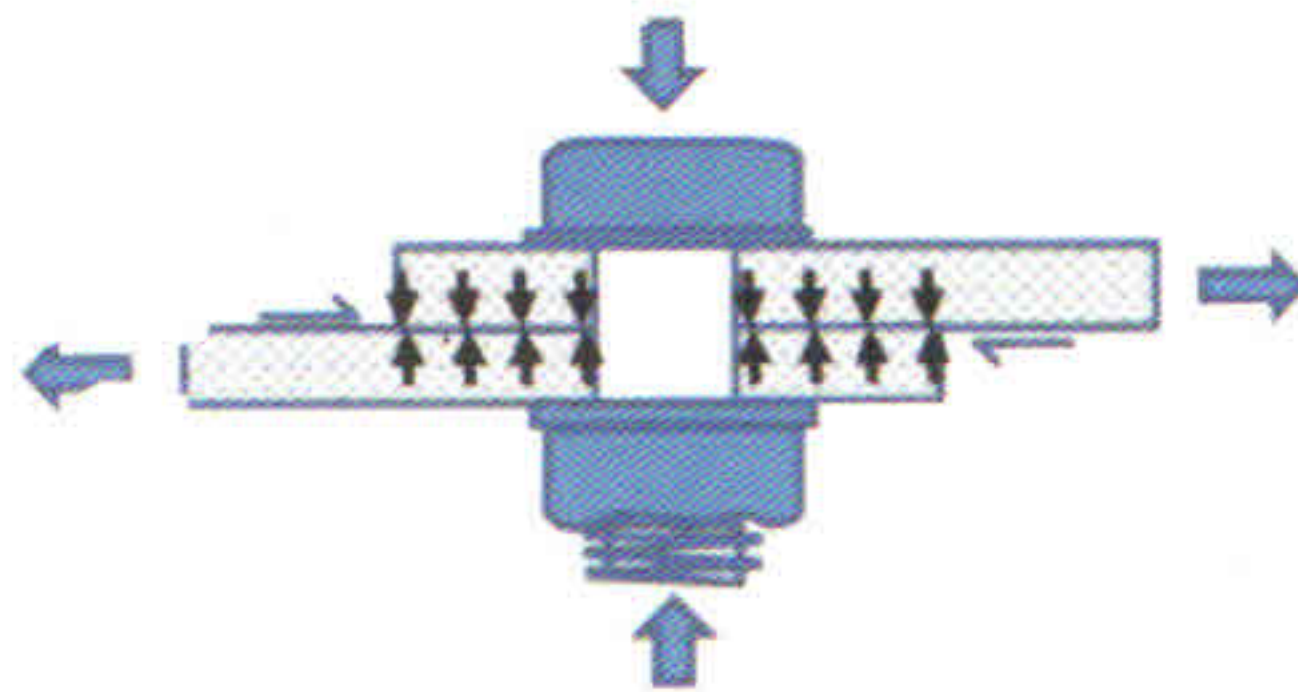

RANGE OF HIGH STRENGTH STRUCTURAL FASTENERS:

Product	Specification	Size	Threads	Mechanical Properties
HSFG BOLTS	IS 3757		Metric Coarse, 6g IS 4218	Property class 8.8 or 10.9 IS 1367 part 3
HSFG NUTS	IS 6623	M 16 to M 36	Metric Coarse, 6h IS 4218	Property class 8 or 10 IS 1367 part 6
HSFG WASHERS	IS 6649			HARDNESS 35 - 45 HRC

IS 4000 – is the Code of Practice for High Strength Friction Bolts.

Applied bolting Technology SQUIRTER DTIs

DTIs are Mechanical Load Cells

As mechanical load cells, DTIs indicate tension using bump compression generated directly during tightening. Since the bumps must physically compress under actual Clamp load, DTIs are the only tensioning method verifying that bolts have achieved the required tension, as inspected with feller gauge.

Squirter® DTIs Improve constructibility

As an improvement to a DTI's constructibility, Applied Bolting squirter, DTIs indicate Bump compression visually, without feller gauge. Feller gauges can still be used, but squirter allow by installers and inspectors.

It's all about Tension

Structural bolting requires a predetermined amount of Clamp load or tension within fasteners for each connection to transfer loads as designed. Tension is the amount of force between plies that keeps buildings sound and industrial complexes running smooth. It is only achieved by stretching bolts during installation.

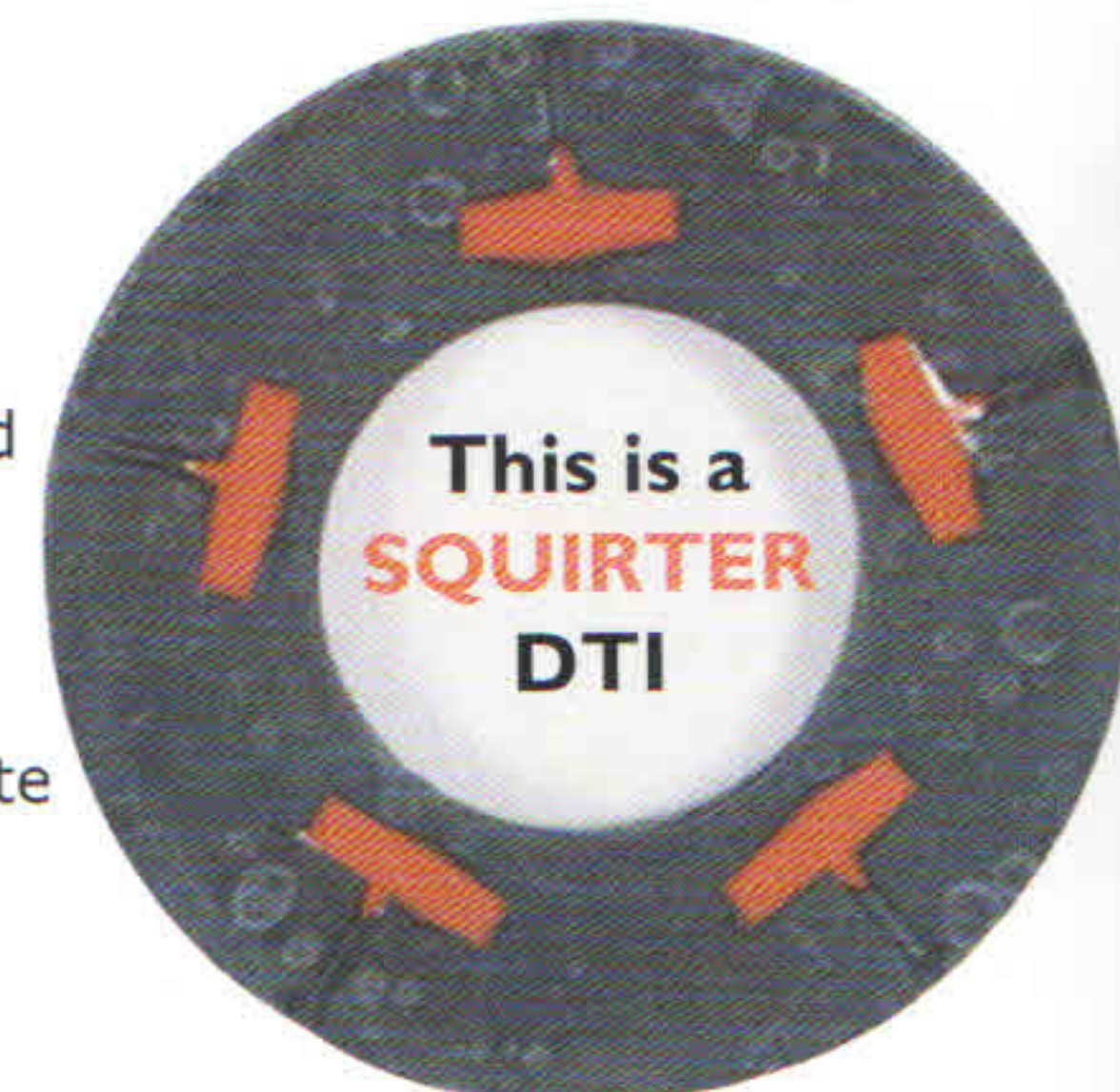

ANCHOR BOLTS AND ANCHOR THREADED RODS



Surecon manufactures and stocks in both black and galvanized finish of headed anchor bolts, threaded anchor rods, plate welded and bent anchor bolts from 1/2" diameter in a variety of different configurations and IS / ASTM specifications.

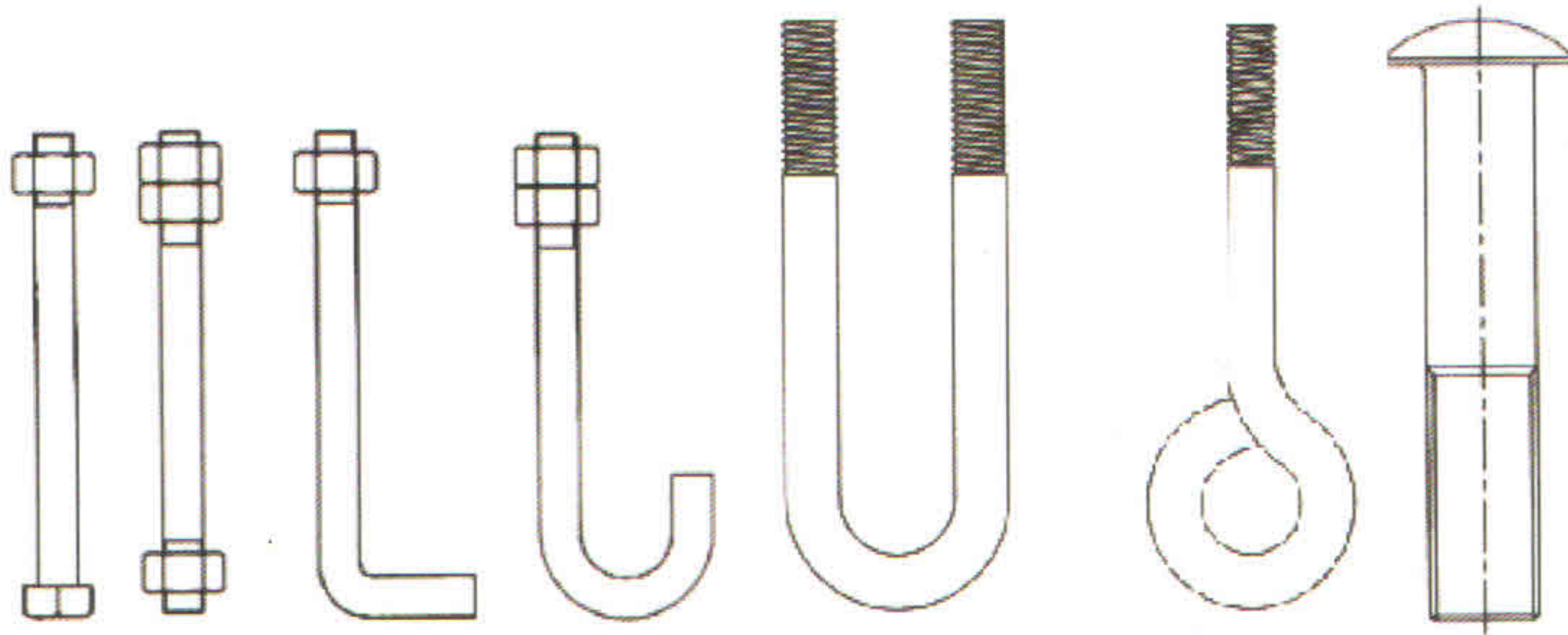

GRADES FOR BOLTS / STUDS

IS / ISO / DIN : Grade 4.6, 4.8, 5.6, 5.8, 6.8, 8.8, 9.8, 10.9, 12.9

ASTM A 193 : Grade B6, B7, B7M, B16, B8, B8M, B8T

ASTM A 307 : Grade A and B

ASTM A 320 : Grade L7, L7M, L43

ASTM A 325/A 490 : Type 1

GRADES FOR NUTS

IS / ISO / DIN : Grade 4, 5, 6, 8, 10, 12

ASTM A 194 : Grade 2H, 2HM, 6, 7, 7M, 8, 8M, 8T

ASTM A 563 : Grade A, B, C, D and DH

DESCRIPTION	RANGE
Anchor Bolts, J Bolts, L Bolts, T Bolts, U Bolts	M12 to M100 (and imperial equivalents) upto length 6 metres
Standard Bolts & Special Bolts as per drawing	M12 to M100 (and imperial equivalents) upto 6 metres
Hot Forged Nuts	M12 to M100 (and imperial equivalents)
Studs	M12 to M100 (and imperial equivalents)

SURFACE COATING

XYLAN / PTFE	Zinc Plated
Hot Dipped Galvanised	Phosphated
Molycoated	Silver Plated
Ni-Cad Plated	Nickle Plated



STUD WELDING / SHEAR CONNECTORS

(TYPE SD acc. To ISO 13918)



KOCO Germany is one of the world's leading manufacturer of stud welding equipment and shear studs.

KOCO is one of the first companies to achieve "CE" marking for the best quality in shear studs.

KOCO STUDS IN India are approved and tested by Railways / RITES / NTPC

D1	L1	D5	h3	L1BurnOff*
13	25-400	25	8	3
16	35-525	32	8	4
19	50-525	32	10	4
22	50-525	35	10	4
25	75-525	40	12	6

Acc. of the above sizes in mm.

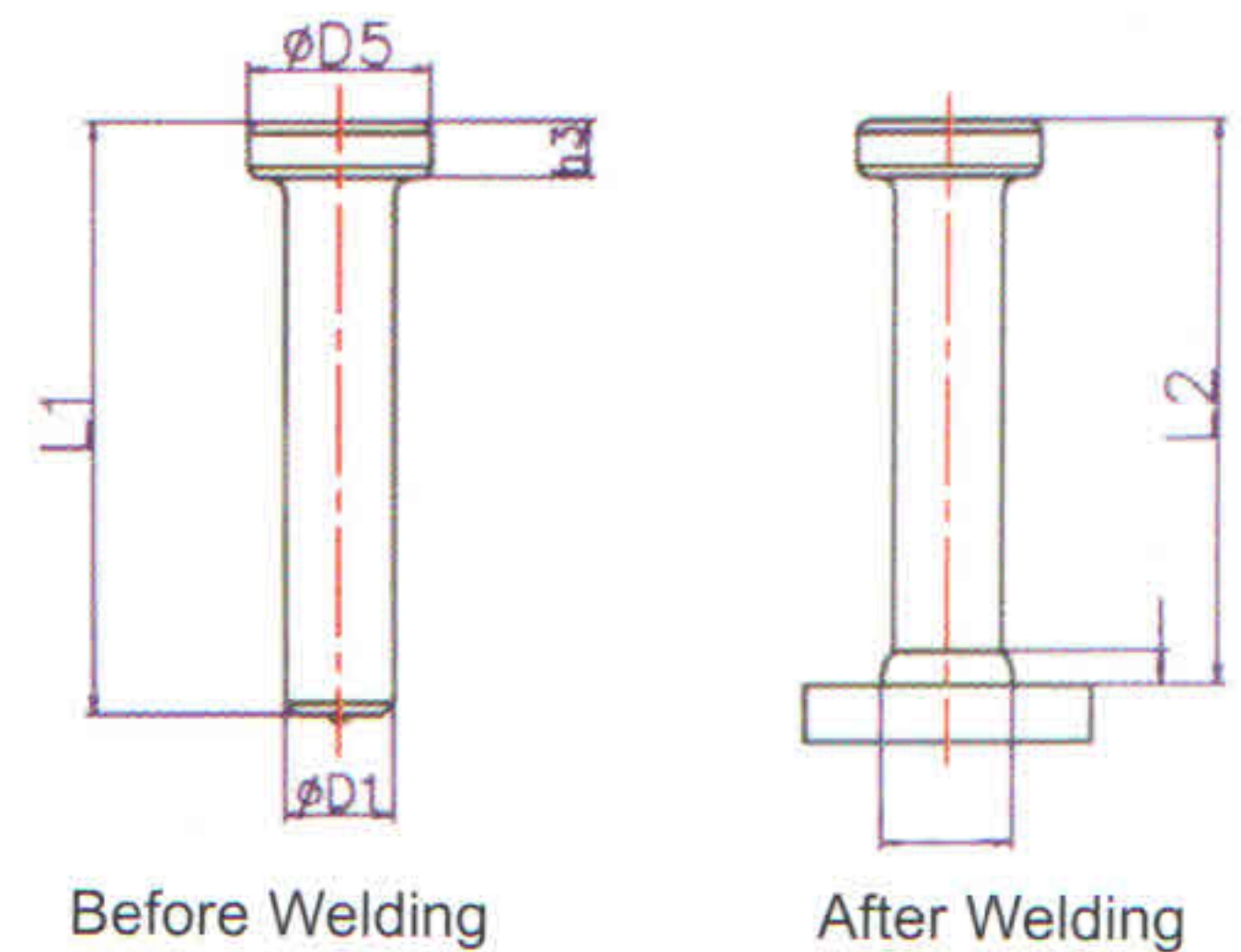

Shear connectors are typically used in composite steel construction to tie the concrete to steel members and resist shear forces between the concrete slab and steel members. They are widely used in steel building, bridges etc. Welding through metal deck are available for this stud, for this option, special ferrule type UFT are recommended.

KOCO - STUD WELDING - SAFETY AND INNOVATION

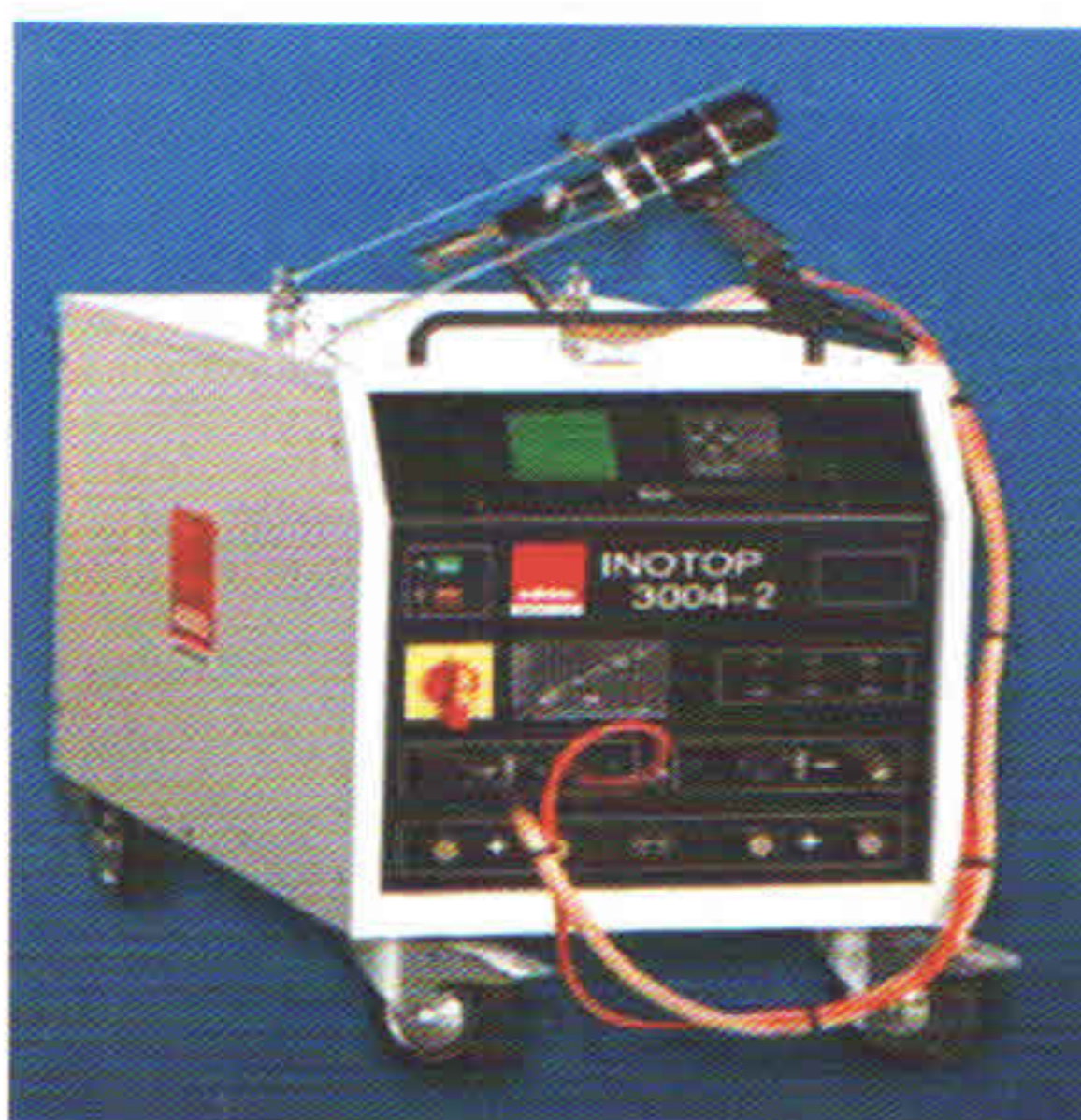

KOCO STUD WELDING

All models of the ELOTOP compact stud welding equipment series are laid out for top performance as well as highly cost-effective drawn arc stud welding. Through their special features they are designed for rough wear on building sites and continuous operation.

• Welding Dia.:	3 mm to 25 mm
• Max. Current:	450 to 3500 amps
• Time :	20 - 2000 m/sec.
• Max. Studs per minute:	19 mm - 12 studs 22 mm - 9 studs 25 mm - 6 studs

Lightest 25mm stud welding machine in the market (weighs only 63 kgs.)

Advantages :

- Microprocessor control ensures optimum welding results during continuous welding.
- Fully Controlled Thyristor bridge power source.
- Current regulation and high performance ensure precise repeatability.
- The intelligent self-diagnosis system increases productivity through minimum machine downtime.
- Digital interface for accurate setting of current and time parameters to ensure precise, repetitive welds.



PRODUCTS:

Fasteners hot forged and machined
Screws, bolts, nuts
Threaded rods according to ASTM/ASME
Plugs Hot Forged and Machined
Rolled Rods and Machined
Studbolts rods
Any other Fastener as per your
specification / drawing

MATERIALS:

Stainless Steel Material

Titanium

MONEL

INCONEL

DUPLEX

SUPER DUPLEX

HASTELLOY

SPECIAL GRADES

GRADE:

B8, B8M, B8A, B8C,
B8MA, B8M2, B8M3

TiGr.1, TiGr.2, TiGr.5
TiGr.7

400, K500 (MONEL)@
600, 825, 625, 800 H
(INCONEL)@

2205 DUPLEX@
32760 (SUPER DUPLEX)@

C276 (HASTELLOY)@
.660, B5, B6, B7, B7M
L7, L7M, L43, B16

COATINGS:

Bright Zinc Plating, ZincNickel Plating, Hot Dip Galvanising, Phosphatided, Nickel Plating,
Black Oxide, Chromium Plating, Cadmium Plating, GEOMET®, Xylan/PTFE®,
Fluoropolymer and other finishes on demand.



Diameter : M 8 - M100

Length : 25 mm to 5 meters.

And moreover:

All fasteners will be supplied with complete third party inspection
as per BQVI 1.3 inspection test procedures.

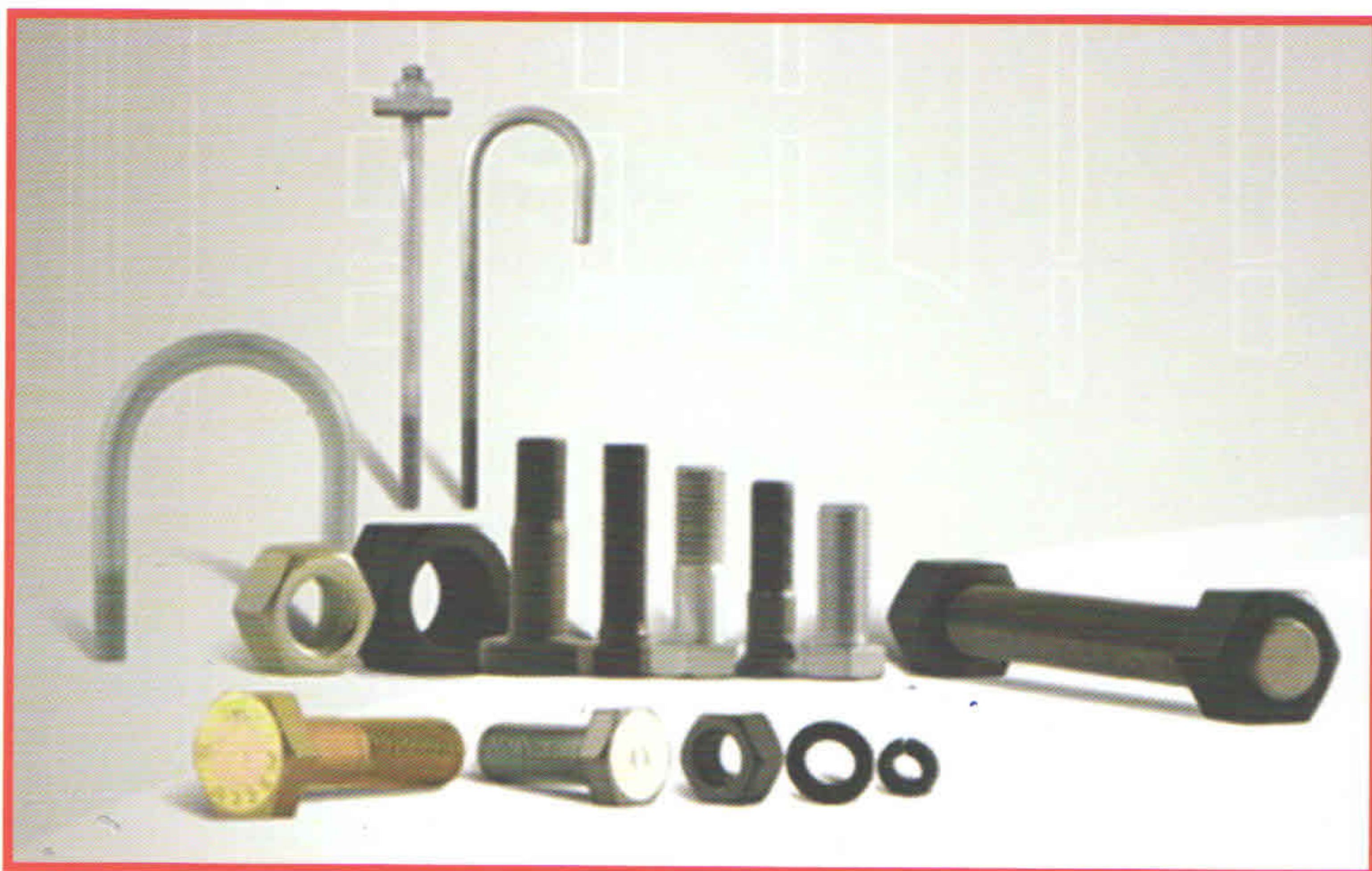

SURECON FASTENING & ENGINEERING PVT. LTD.



An ISO 9001 Co.

Regd. Off. : 003/B Ramji House, Ground Floor, #30 Jambulwadi Kalbadevi, Mumbai 400 002
Fact. Add. : 79/80 The Bombay Timber Market, Signal Hill View, Reay Road (E), Mumbai 400 010
CIN : U45202MH2009PTC194065 | **PAN** : AANCS2358B
Phone : +91-22-4022 4770 / 4022 4771 / 2208 4474 / 2208 5566 / 2208 5561
E-mail : sales@surecon.in / account@surecon.in
http : www.surecon.in